

ME7A6066 Assembly Manual

Colin Power Recliner with Swivel and Glider

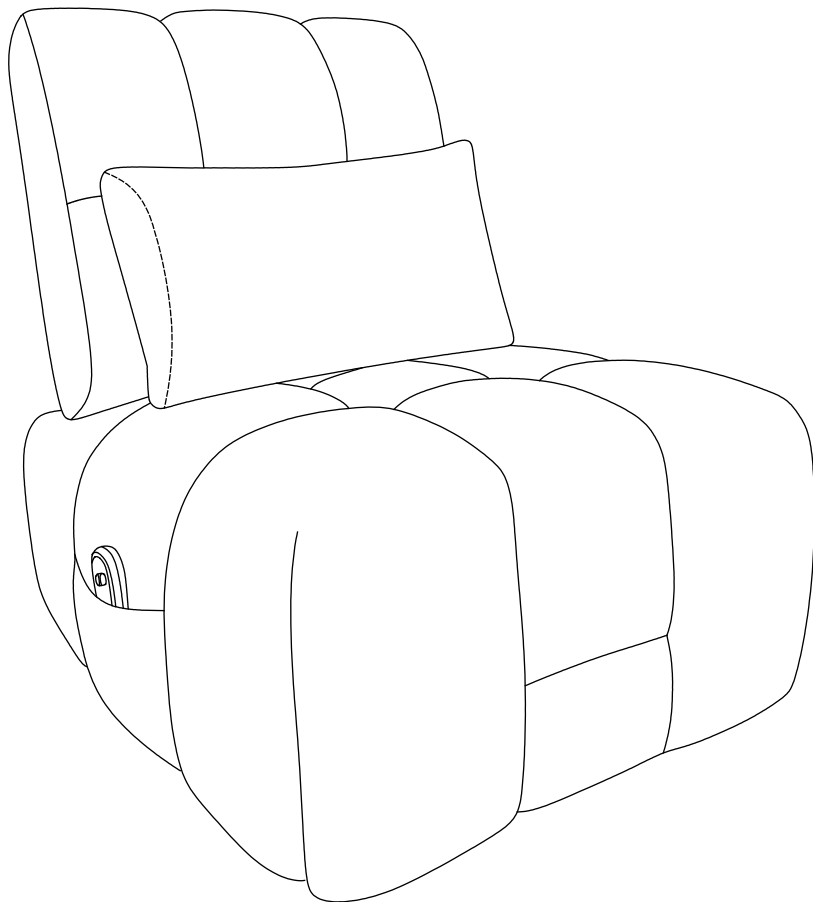

CAUTION

THIS ASSEMBLY MANUAL CONTAINS IMPORTANT SAFETY INFORMATION.

PLEASE READ AND KEEP FOR FUTURE REFERENCE.

Count parts before assembling.

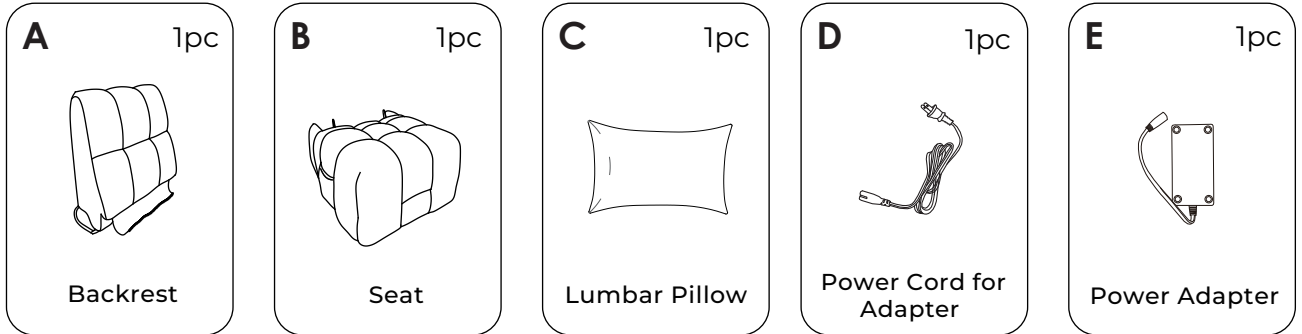

Step 1

Cut the plastic ties to release the swivel base.

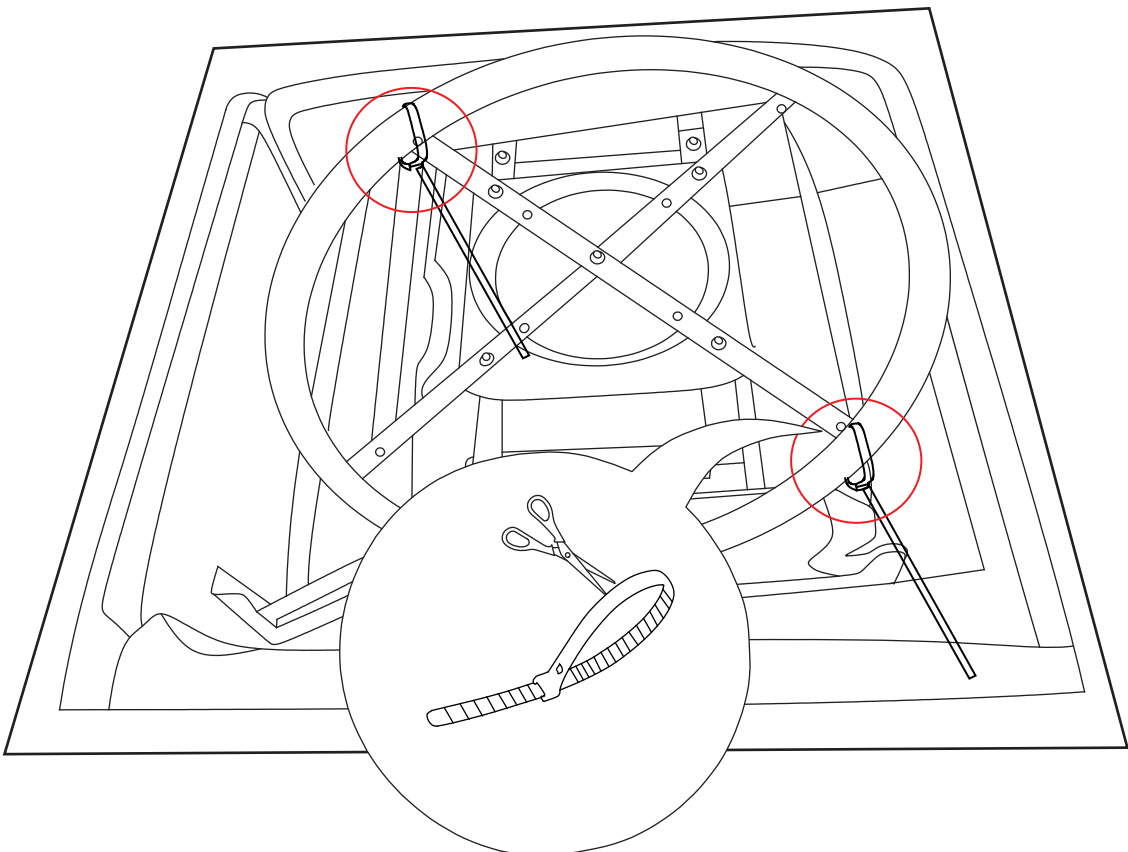

Step 2

Locate the Lumbar Pillow (C) and the hardware pack at the back of the Seat (B).

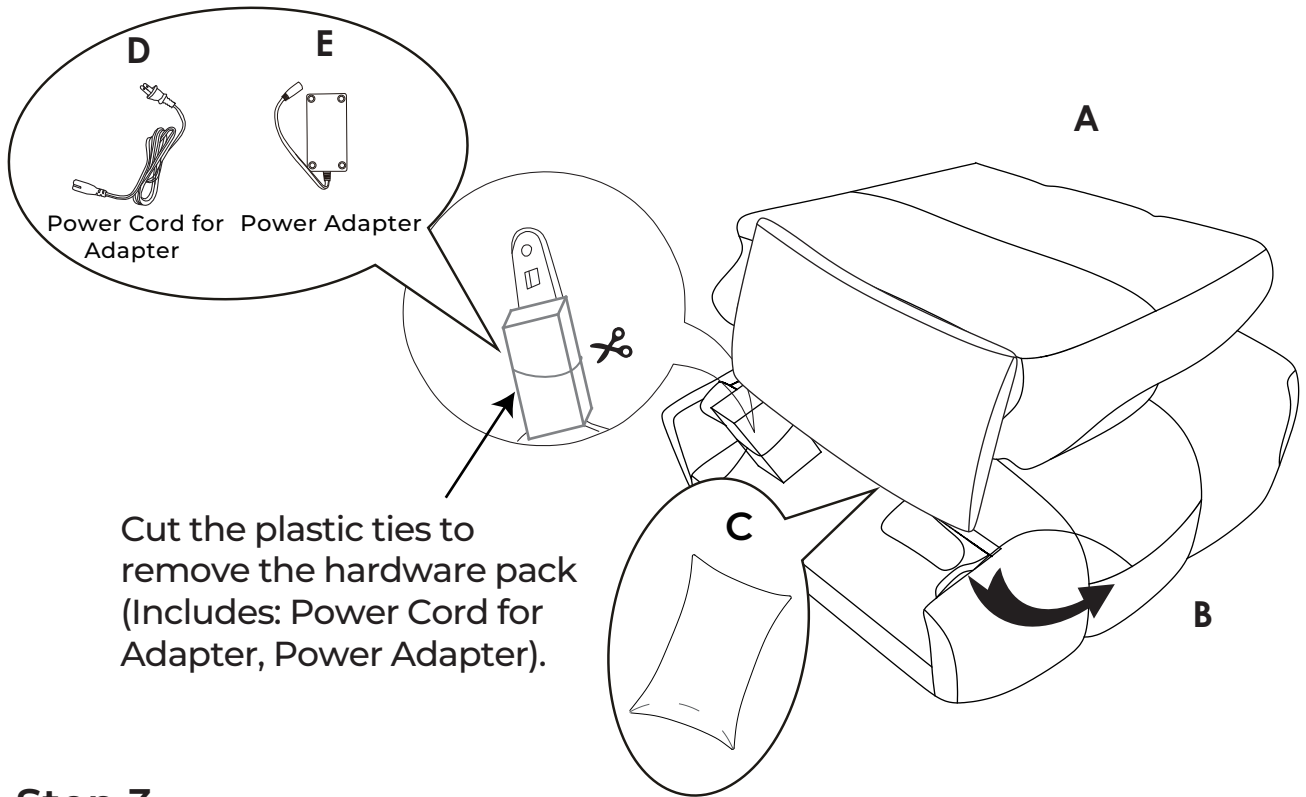

Step 3

Zip up the bottom of the Back (A) and the Seat (B) together.

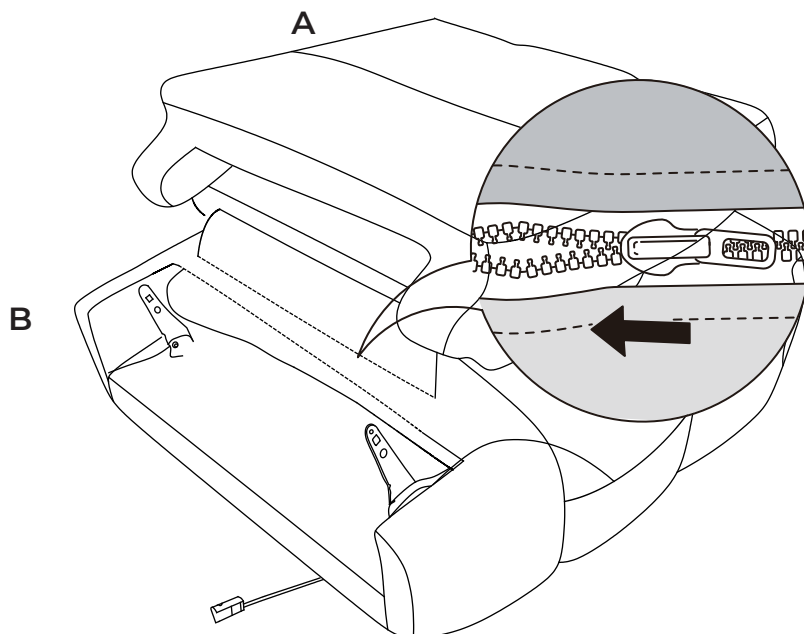

Step 4

Slide the Back (A) into the metallic quick connectors of the base.

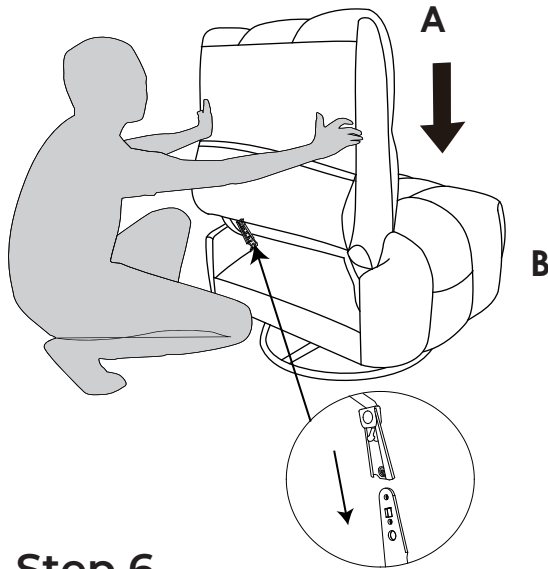

Step 5

Push down the Back (A) firmly until each side is locked into place and an audible "click" is heard.

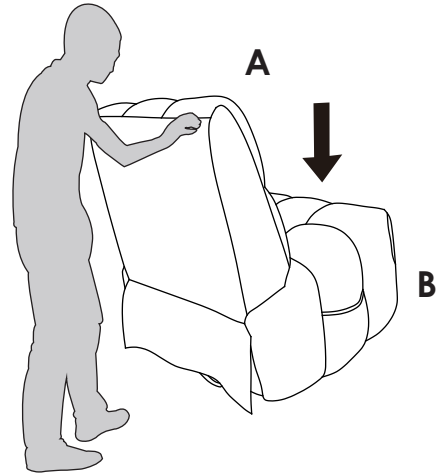

Step 6

Locate the Power Adapter (E) and connect to its corresponding receiver on base of the Seat (B). Connect one end of the Power Cord for Adapter (D) into the Power Adapter (E).

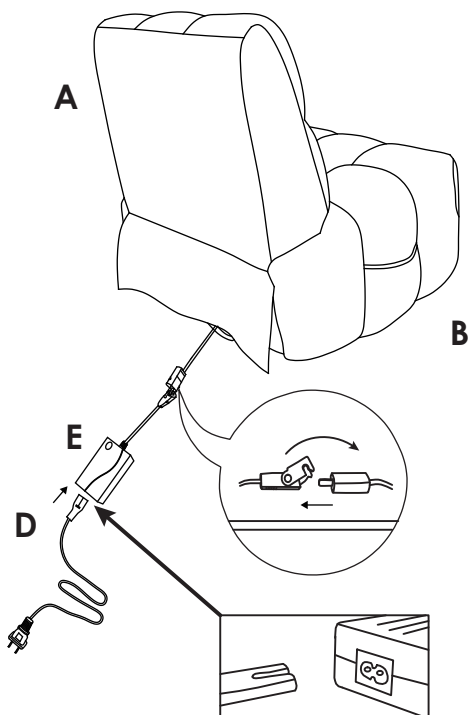

Step 7

Attach the back cover to the bottom of the seat with Velcro.

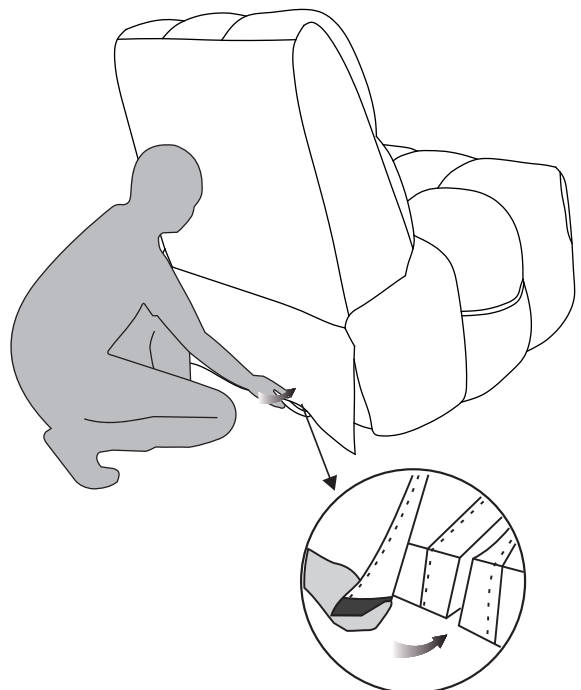

Step 8

Plug the Power Cord for Adapter (D) into the power outlet.

Note: After all the connections are made, the green LED will light up.

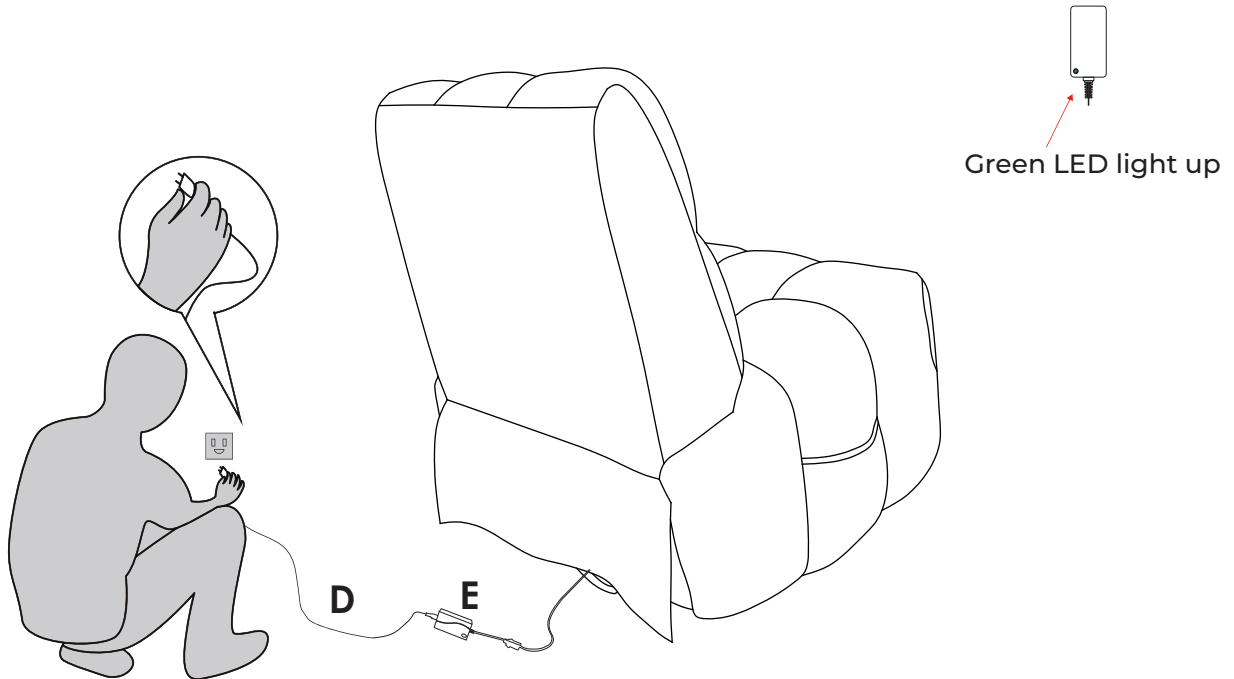

Step 9

Place the Lumbar Pillow (C) on the seat and enjoy your new piece of furniture.

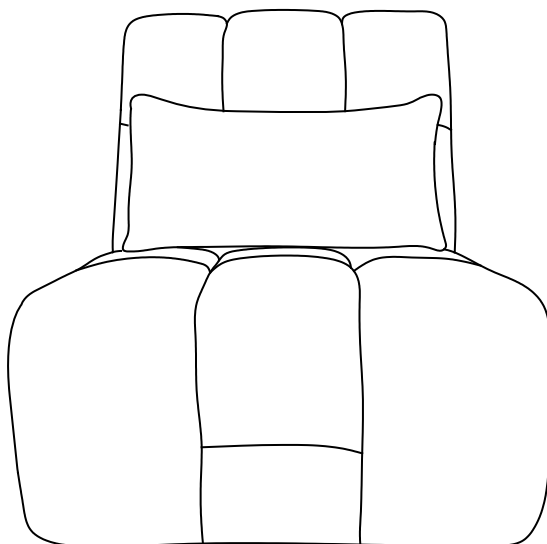

How to Operate

Remote Control for Reclining

Press and hold to recline the back and raise the footrest.

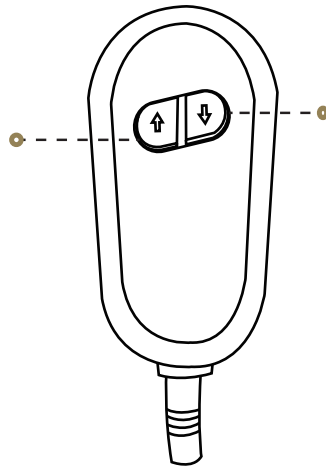

Press and hold to raise the back and lower the footrest.

WARNING

- Do not leave when the recliner is not fully closed.
- Do not sit on the footrest when the mechanism is open.
- Do not jump or roughhouse on the furniture.

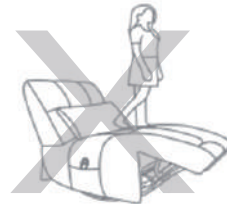
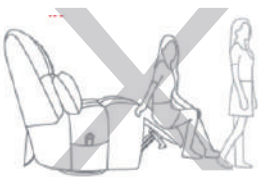

- Make sure there are no obstacles under or in front of the footrest.
- The reclining mechanism should only be operated while seated properly.
- Do not lean on the back.



- Do not reach under the seat when the mechanism is operating, or serious injury may occur.
- Do not continuously operate mechanism for more than one minute, or unit may go into protection mode by shutting down to prevent overheating.
- If the unit must be moved, do not drag it. The unit must be lifted in order to be moved.